

CLINICON EQUIPMENT DRAPES

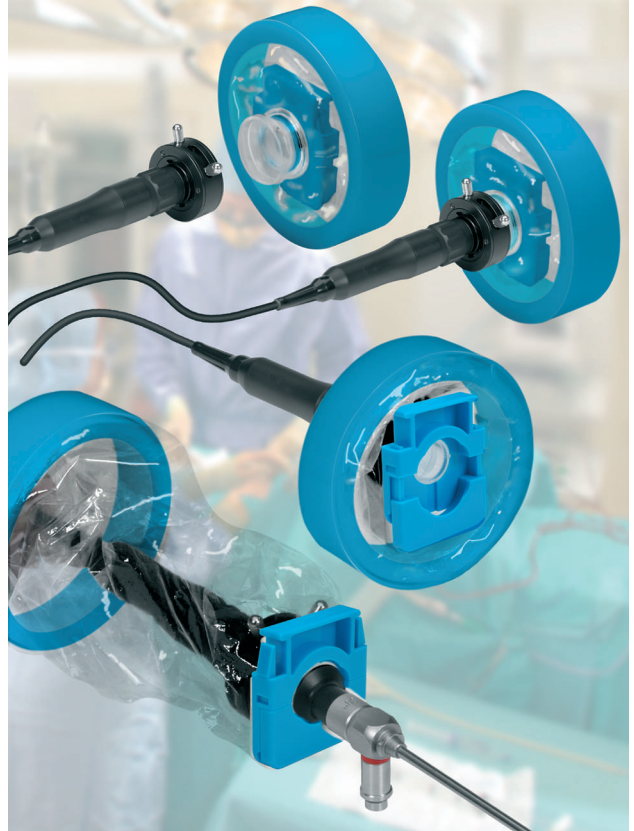

MICROSCOPE DRAPE



QUICK CHANGE CAMERA DRAPE

Extensive range of sterile disposable drapes, all manufactured in cleanroom conditions complying with Medical Devices Directive 93/42/EEC.

Bespoke variations of existing designs and patterns can also be developed on request, with a fast response to customer suggestions and requirements.

CAMERA DRAPES

Many formats, including concentric ring, telescopic, concertina and flat folded.

C-ARM DRAPES

Various configurations.

PROBE DRAPES

Designed for lithotripter and ultrasound probes.

MICROSCOPE DRAPES

Various flat folded sizes, also bonnet style.

KEYPAD COVERS



AVAILABLE via NHS SUPPLY CHAIN

QUICK CHANGE CAMERA DRAPE

Concentric ring style, with simple 2-step fitting

CE 0120

Simple 2-step fixing method ensures ease of use and complete security. Scope can be quickly and easily changed during procedures without compromising sterility. Broad edged ring reduces the risk of non-gloved personnel contaminating material entering the sterile field.

Sterile, single use.
Packed singly, 50 per box.

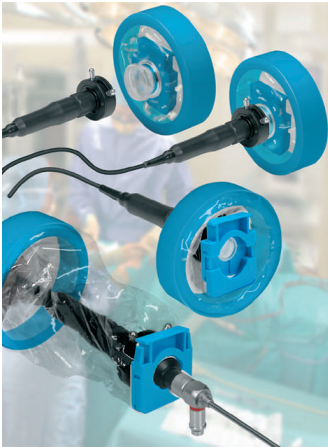

Ref. ECE 150-250C NPC Code FBE228
Size 150mm x 2.5m.
Ring aperture 85mm.

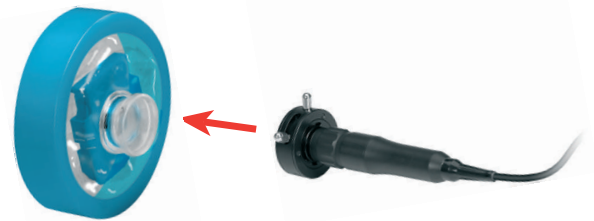

1 Attach camera

Push-fit is simple and secure.
Drape can then be extended over camera and cable, simply by pulling back the ring.
Any excess drape is retained inside the ring.

2 Attach scope

Simple snap-on fitting is quick and secure.

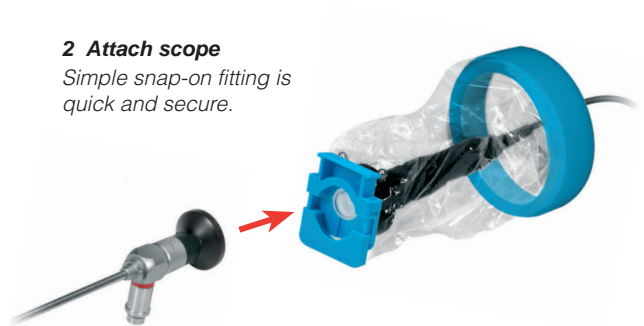

CAMERA DRAPES, CONCENTRIC RING STYLE

CE 0120

Drape is contained within ring which can be pulled back over camera without compromising sterility. Any excess material remains within the ring. Broad ring reduces the risk of non-gloved personnel contaminating material entering the sterile field.

Size 150mm x 2.5m. Ring aperture 85mm.

Sterile, single use.
Packed singly, 50 per box.

Code ECN 150-250 NPC Code FBE001
With two simple adhesive tape closures.

Code ECN 150-250S NPC Code FBE229
With two twist-lock spring clips and one adhesive tape closure.

Code ECN 150-250TK NPC Code FBE195
Elastomeric end section with two adhesive tape closures.

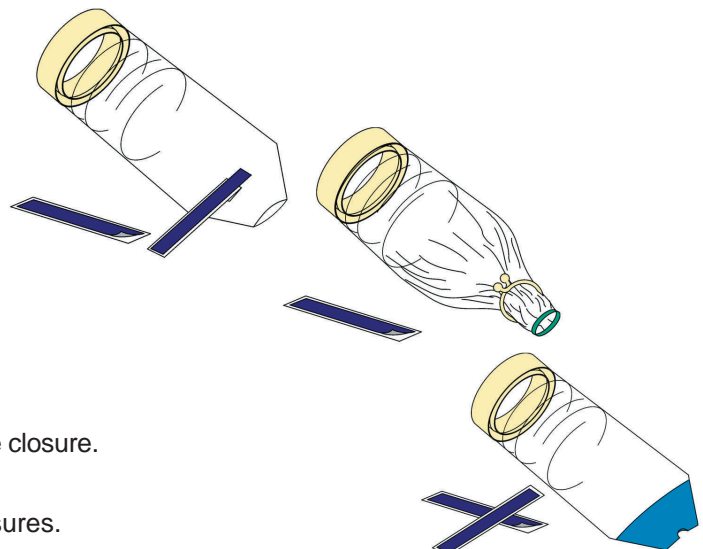

CAMERA DRAPES, TELESCOPIC STYLE

CE 0120

Folded cuff to facilitate application without compromising sterility.

Sterile, single use.
Packed singly, 25 per box.

Code EOD 130-250T NPC Code **FBE196**

With simple plain end and two adhesive tape closures.
Size 130mm x 2.5m

Code EOD 165-250TK

With elastomeric end section and one adhesive tape closure.
Size 165mm x 2.5m
Aperture 10mm dia

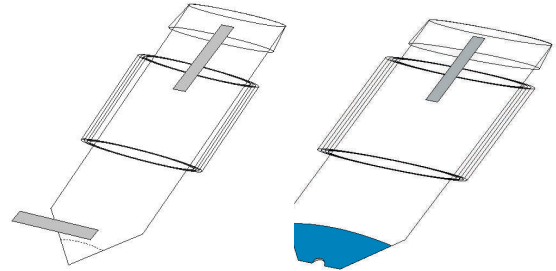

CAMERA DRAPE, CONCERTINA STYLE

CE 0120

Locator insert assists hand access through the drape whilst fitting.
Folded cuff to facilitate application without compromising sterility.
Supplied with two adhesive tape closures.

Sterile, single use.
Packed singly, 25 per box.

Code EOD 150-300 NPC Code **FBE197**

Size 150mm x 3m

Code EOD 165-300

Size 165mm x 3m

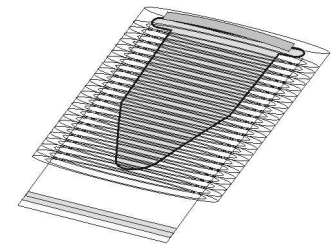

CAMERA DRAPE, FLAT FOLDED STYLE

CE 0120

Folded drape with folded cuffs at both ends to facilitate application without compromising sterility. Supplied with one adhesive tape closure.

Sterile, single use.
Packed singly, 25 per box.

Code EOD 130-250

Size 130mm x 2.5m

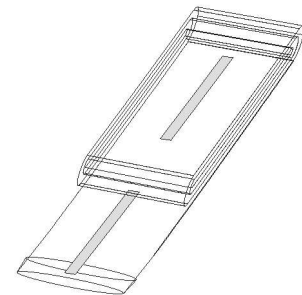

DRILL DRAPE, TELESCOPIC STYLE

CE 0120

Folded cuff to facilitate application without compromising sterility.

Sterile, single use.
Packed singly, 20 per box.

Code EOD 130-100T

Size 127mm x 1m

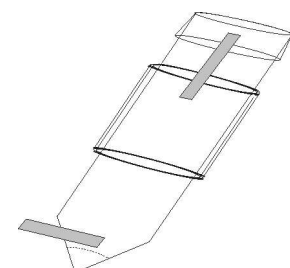

MICROSCOPE DRAPES

To fit specific objective lenses

Clear plastic, with Velcro securing tapes at each eyepiece and three/four gathering straps for making secure. With removable objective lens cover.

Sterile, single use.
Packed singly, 10 per box.

To fit ZEISS OPMI microscopes (objective lens 48mm o/dia)

Code MO3 110-160

Size 1.35 x 1.6m (standard)

Code MO3 110-200

Size 1.35 x 2m (long)

Code MO3 110-260

Size 1.35 x 2.6m (extra long)

To fit ZEISS MD microscopes (objective lens 65mm o/dia)

Code MD3 110-160 NPC Code FBE198

Size 1.35 x 1.6m (standard)

Code MD3 110-200

Size 1.35 x 2m (long)

Code MD3 110-260 NPC Code FBE199

Size 1.35 x 2.6m (extra long)

To fit LEICA / WILD microscopes (objective lens 70mm o/dia)

Code MW3 110-160

Size 1.35 x 1.6m (standard)

Code MW3 110-200

Size 1.35 x 2m (long)

Code MW3 135-240 NPC Code FBE200

Size 1.35 x 2.6m (extra long)

CE0120

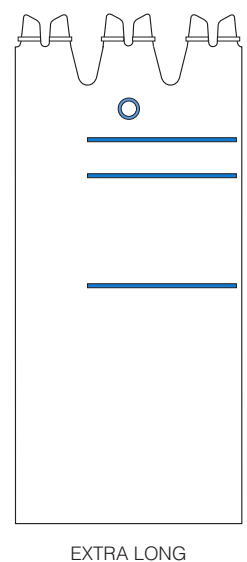
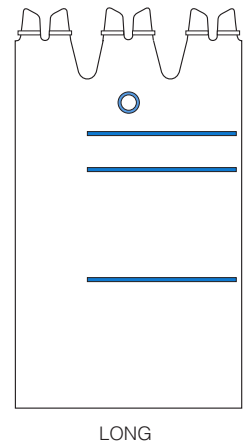
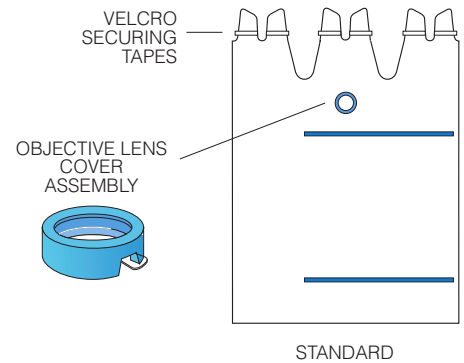

MICROSCOPE DRAPE, UNIVERSAL FITTING

Clear plastic, with elastomeric panel (140mm o/dia, 40mm i/dia) to fit more than one objective lens size. Velcro securing tapes at each eyepiece and three/four gathering straps for making secure.

Sterile, single use.
Packed singly, 10 per box.

Code MC3 106-160

Size 1.35 x 1.6m (standard)

Code MC3 106-260

Size 1.35 x 2.6m (long) **NPC Code FBE201**

See range of Clinicon objective lens covers, if required.

CE 0120

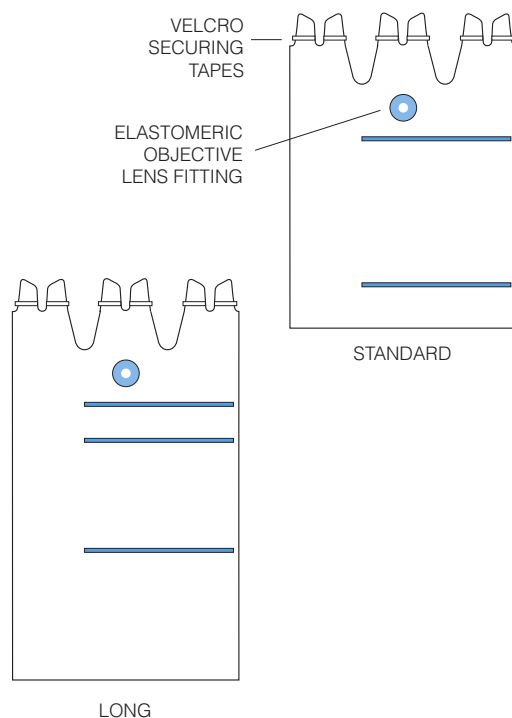

OBJECTIVE LENS COVER

With removable lens protector, for use in conjunction with Clinicon universal fitting microscope drape.

Sterile, single use.
Packed singly, 10 per box.

Code MLC 048

48mm dia (for ZEISS OPMI)

Code MLC 065

65mm dia (for ZEISS MD)

Code MLC 070

70mm dia (for LEICA / WILD)

CE 0120

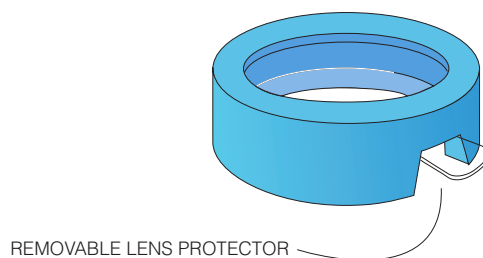

MICROSCOPE HANDLE DRAPES

Clear plastic with adhesive fixing tape.

Sterile, single use.
Packed in pairs, 50 pairs per box.

Code MHD 180-330 NPC Code FBE230

Size 180 x 330mm

CE 0120

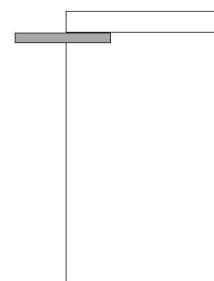

C-ARM FLUOROSCOPE DRAPE

Elasticated collar (contains latex) for easy application and increased security. Large size to accommodate most C-Arms.

Sterile, single use.
Packed singly, 25 per box.

Code CFD 760-090 NPC Code FBE040
Size 760 x 900mm

CONTAINS LATEX CE 0120

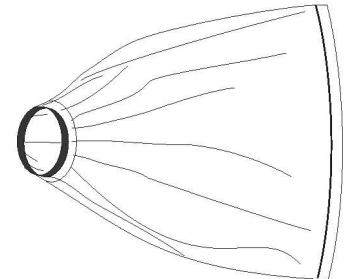

C-ARM DRAPE, EXTRA LARGE

Extra large size to accommodate mobile C-Arms.
Supplied with six adhesive tape closures.

Sterile, single use.
Packed singly, 10 per box.

Code CAD 120-150 NPC Code FBE025
Size 1.2 x 1.5m

CE 0120

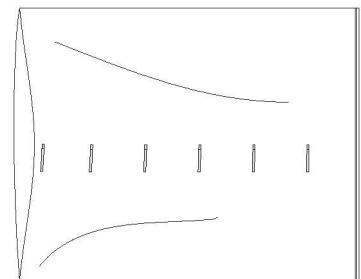

C-ARM DRAPE, SIDE OPENING

Side opening to facilitate easy draping and folded cuff to facilitate application without compromising sterility.
Full-width adhesive tape closure.

Sterile, single use.
Packed singly, 10 per box.

Code CAD 600-100 NPC Code FBE202
Size 600mm x 1m

CE 0120

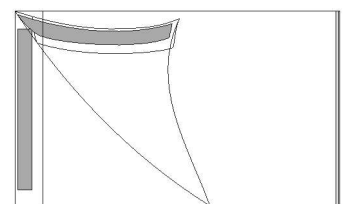

C-ARM DRAPE, FULL SIZE

Fits most C-Arms. Telescopic style and easily applied by one person. Supplied with ten adhesive tape fasteners and four gathering strips.

Sterile, single use.
Packed singly, 10 per box.

Code CAD 265-152 NPC Code FBE203
Size 2.65 x 1.52m

CE 0120

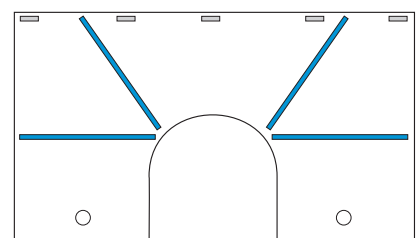

BONNET /BANDED BAG

CE0120

Elasticated collar for easy application and increased security.
Four sizes, with many uses in theatre and X-Ray.

Sterile, single use.
Packed singly, 25 per box.

Code CAB 070 NPC Code FBE204

700mm dia

Code CAB 080 NPC Code FBE041

800mm dia

Code CAB 090 NPC Code FBE231

900mm dia

Code CAB 100 NPC Code FBE205

1.0m dia

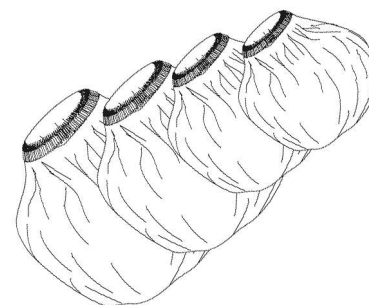

ULTRASOUND PROBE DRAPES

CE0120

Each supplied with two adhesive tape closures.

Sterile, single use.
Packed singly, 25 per box.

Telescopic style Code ULT 127-150T NPC Code FBE206

Size 127mm x 1.5m

Flat folded style Code UGD 130-082 NPC Code FBE207

Size 130 x 820mm

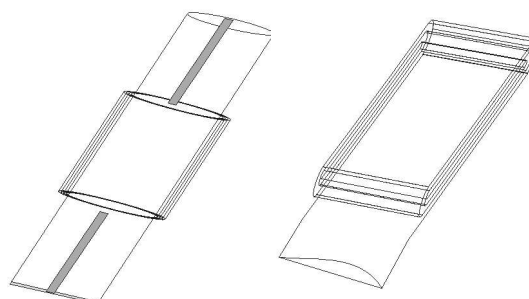

X-RAY SCREEN COVER

CE0120

Transparent film to allow clear view of screen during sterile procedures. Supplied with four adhesive tapes (two full-width).

Sterile, single use.
Packed singly, 25 per box.

Ref. SCC 090-120 NPC Code FBE208

Size 900 x 1200mm

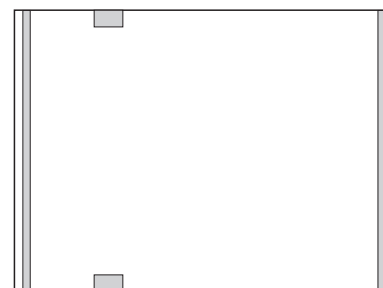

MEMBRANE KEYPAD DRAPE

Simple clear cover for security when using equipment keypad during sterile procedures. Supplied with four adhesive fixing tapes.

Sterile, single use.
Packed singly, 25 per box.

Ref. KPD 200-210
Size 200 x 210mm

CE 0120

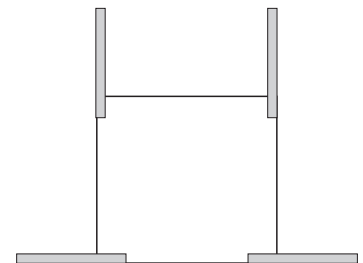

COLPOSCOPE DRAPE, UNIVERSAL FITTING

Clear plastic with elastomeric panel (140mm o/dia, 40mm i/dia) to fit more than one objective lens size.

Single use.
Packed under cleanroom conditions, 100 per box, non sterile.

Code ID0001NS
Size 840 x 760mm

CE 0120

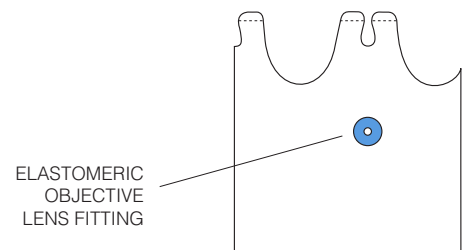

CLINICON PATIENT DRAPES

Extensive range of sterile patient drapes, all manufactured in cleanroom conditions complying with Medical Devices Directive 93/42/EEC. Bespoke variations of existing designs and patterns can also be developed on request, with a fast response to customer suggestions and requirements.

UROLOGY DRAPE

Blue plastic film for excellent shape conformity. 50mm wide adhesive strip with finger lift for easy application and positioning. Latex finger cot with additional adhesive ring around the base.

Aperture 60mm dia.

Sterile, single use.
Packed singly, 10 per box.

Code URO 600-090

Size 600 x 900mm

Code URO 600-126

Size 600mm x 1.26m

CONTAINS LATEX C€0120

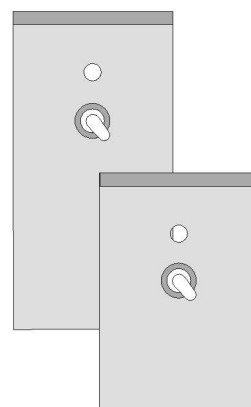

DRAINAGE POUCH

Strong clear laminated construction for durability and good visibility. Half moon filter screen and fluid pouch with reinforced strip to retain shape. 195mm wide adhesive strip, full width and shaped, for secure positioning. Drainage spigot with cap.

Sterile, single use.
Packed singly, 25 per box.

Code DPO 500-049

Size 490mm (wide) x 500mm

C€0120

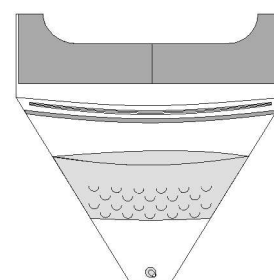

U-DRAPE

Blue plastic film. Adhesive tape with finger lift for easy application.

Sterile, single use.
Packed singly, 25 per box.

Code UAP 130-120

Size 1.2 x 1.3m

C€0120

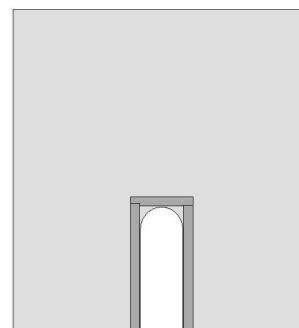

LOWER LIMB EXCLUSION DRAPE

CE 0120

Clear plastic. Folded cuff has full width 50mm adhesive strips with finger lift for easy closure.

Sterile, single use.
Packed singly, 10 per box.

Code LLD 400-700
Size 400 x 700mm

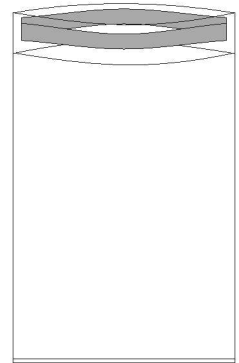

MAXILLO-FACIAL DRAPE

CONTAINS LATEX CE 0120

Blue plastic film for shape conformity, with latex finger cot. Full width 50mm adhesive tapes with finger lift, and adhesive ring surrounding each aperture.

Sterile, single use.
Packed singly, 10 per box.

Code MXF 600-950
Size 600 x 950mm
Apertures 60mm dia

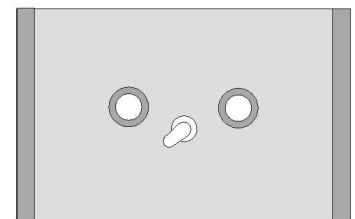

SMALL APERTURE DRAPE

CE 0120

Blue plastic film for shape conformity. 100mm square adhesive tape around aperture, with finger lift for easy application.

Sterile, single use.
Packed singly, 25 per box.

Code SMA 400-040
Size 400 x 400mm
Aperture 60mm dia

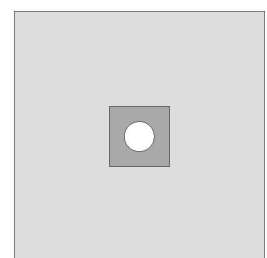

LARGE DRAPE WITH APERTURE AND POUCH

CE 0120

Blue plastic film, with fluid collection pouch. 156mm square adhesive area around aperture.

Sterile, single use.
Packed singly, 10 per box.

Code MAS 100-220
Size 1.0 x 2.2m
Aperture 60mm dia

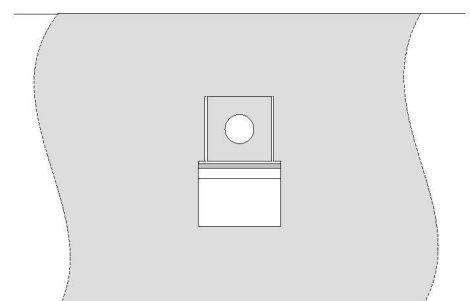

TOURNIQUET DRAPE

CE

Blue plastic film suitable for both upper and lower limb procedures. Quickly applied, with two full width adhesive strips (25mm and 30mm) for maximum effectiveness. Designed specifically for tourniquet cuff based procedures, to keep the padding and tourniquet cuff clean and dry during pre-op skin preparation.

Single use.
Packed singly under cleanroom conditions, 100 per box.

Code TRN 090-300NS **NPC Code FBE042**
Size 300 x 860mm

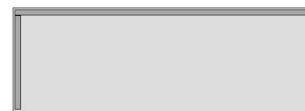

ELASTOMERIC TOURNIQUET DRAPES

CE

Clear plastic with elastomeric panel for quick and efficient application. Suitable for both upper and lower limb procedures.

Single use.
Packed singly under cleanroom conditions, 50 per box.

Code TRA 060NS
Size 550 x 650mm. Aperture 60mm dia.

Code TRA 075NS
Size 550 x 650mm. Aperture 75mm dia.

Code TRA 100NS
Size 550 x 650mm. Aperture 100mm dia.

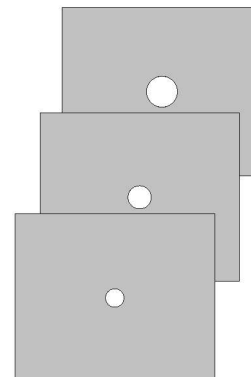

ABSORBENT PROCEDURE DRAPE

CE 0120

Blue plastic film with white absorbent pad to absorb up to 1 litre of fluid. Drier floors lead to a safer environment and faster patient turnaround.

Sterile, single use.
Packed singly, 25 per box.

Code APD 090-125
Size 900mm x 1.45m
Aperture 120 x 60mm (150mm using perforation).
Absorbent pad size 560 x 820mm

Also available as part of procedure pack for flexible cystoscopy.

